

Nova StatStrip Glucose and β -Ketone Hospital Meter

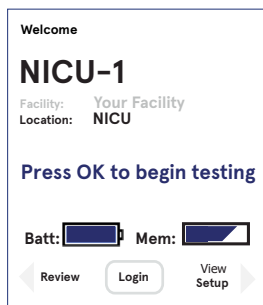

1 Press **Login** and scan or enter Operator ID. Press **Accept**.

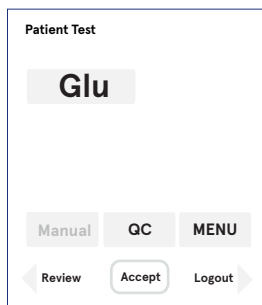

2 Switch to quality control test by pressing **QC** or press **Accept** to perform a patient test.

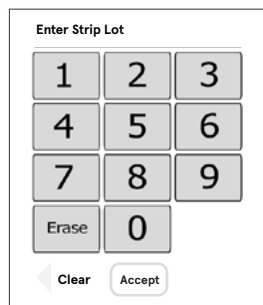

3 Scan strip lot number from the barcode at the test strip vial and press **Accept**.

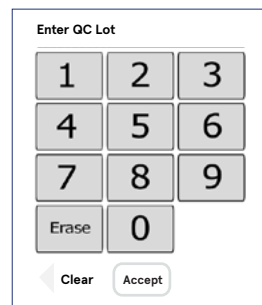

4 Scan or enter patient ID or QC material LOT number. Press **Accept**.

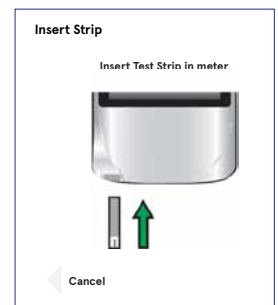

5 Insert test strip into meter.

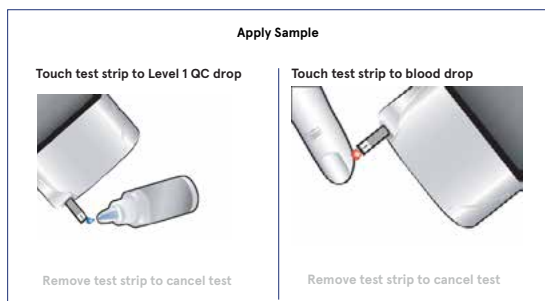

6 Enter sample to the end of the strip by touching the strip to the QC drop or patient blood. Keep the meter on flat surface or upright. Gently mix the control solution before use and discard the first drop of control material. **Note:** Do not get sample material into the strip port.

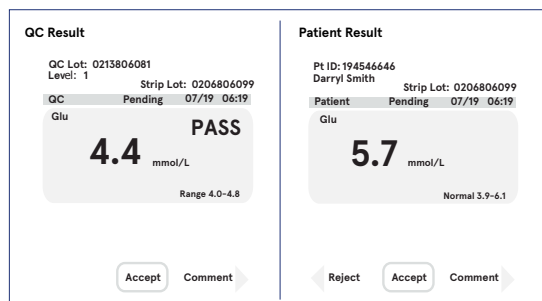

7 The meter will display the result. Patient test result can be accepted by pressing the **Accept** button. By pressing the **Reject** button result can be rejected and a comment can be added to the result with the **Comment** button. For QC material the meter will show **Pass** or **Fail** to indicate if QC test was passed.

Use ejector button on the back of the meter to eject the used strip.

Please consult the instructions for use before performing the test.

Additional features may be enabled for the meter.

Nova StatStrip Glucose and β -Ketone Hospital Meter



- For all professional healthcare settings
- Place the meter into the docking/charging station when it is not in use
- Clean with 70% isopropyl alcohol, 10% dilution of commercial grade sodium hypochlorite or commercial surface decontamination preparations
- Do not spray liquid directly to the meter or immerse into liquid

Nova StatStrip Glucose and β -Ketone Control Solution

- Store control material vial tightly closed under 30°C
- Do not refrigerate or freeze.
- Open vial stability is up to 3 months or until expiration date.

Nova StatStrip Glucose and β -Ketone strips

- Store strips at 15°C–30°C.
- Use strips within **expiration day** or glucose test **within 180 days** of opening the vial and β -Ketone strips within **90 days** of opening the vial.



Sample material

- Wash patient's hands or clean with alcohol pad and dry completely before taking the sample.
- The test strip must be filled in a one go. Do not add more sample.
- For capillary finger stick, venous whole blood and arterial samples.
- Suitable also for neonatal samples and patients receiving intensive medical therapy.
- Suitable anticoagulants: sodium, lithium, and ammonium heparin.

Troubleshooting



Analysis canceled: The test has been canceled, repeat the test with a new strip. Leave the test strip in place until the result is displayed on the screen.

Bad sample: Insert a new strip and rerun the test. If the error code persists, perform the test using an alternate test strip vial or alternate method.

Replace strip: Occurs after insertion of strip or occurs during analysis. Insert another strip and retest. If the error code persists, perform the test using an alternate test strip vial or alternate method.



Temperature: Meter will only work within the temperature range of 1°C–40°C. Return the meter to an environment within the specified temperature range 1°C–40°C.



Flow error: The specimen was incorrectly drawn into the test strip due to either insufficient or incorrect sample application. Repeat the test with a new strip. If the error code persists, perform test using an alternate method.



Transfer failed: Server refuses to allow dialog with meter, or Connection to server was broken. Please check the network settings, status of your network, or contact your administrator for assistance.



Transfer failed: The meter was removed before data transfer was complete. Please re-dock the meter.

Contact info

Aidian Oy

aidian@aidian.eu / +358 10 309 3000

For orders: orders@aidian.eu

www.aidian.eu

Product	Product no.	Order no.
Nova Statstrip Glu Ket Meter	53712	154722
Nova Statstrip-Glu Ket Meter Wifi 1.86	54796	154767
Nova Statstrip Glucose Test Strips, 100T	42214	154727
Nova Statstrip Ketone Test Strips, 50 T	46951	154726
Nova Statstrip Glu Ket Control Level 1	46947	154725
Nova Statstrip-Glu Ket Control Level 2	46948	154766
Nova Statstrip Glu Ket Control Level 3	46949	154723
Nova Dock Single For Ver-1.75/.86	53400	154724